

PRIMARY APPLICATION

DODGE

Dodge RAM 2500 4 X 4 (1994-2010)
 Dodge RAM 3500 4 X 4 (1994-2010)
 RAM 2500 4 X 4 (2011-2019)
 RAM 3500 4 X 4 (2011-2018)

TOOLS REQUIRED

- 1 Floor Jack
- 2 Jack Stands
- 4 Wheel Blocks
- 1 Small Length of 2x4

PARTS LIST

Item	QTY	Part#	Description
A	1	511427	SumoSprings (black) -47 Drivers Side
B	1	511428	SumoSprings (black) -47 Passengers Side

APPROXIMATE INSTALL TIME

🕒 30-60 Min

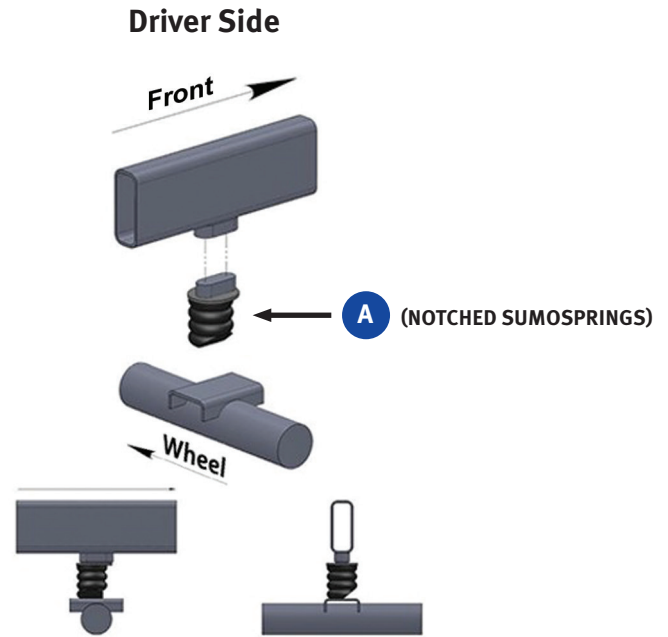

Passengers Side

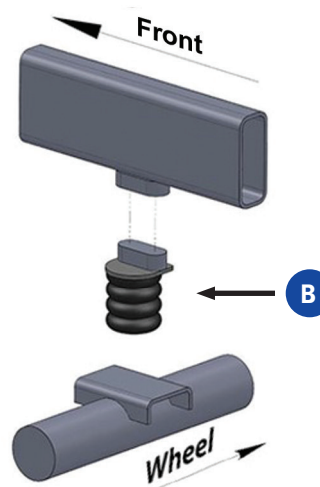

Never exceed the manufacturer's Gross Vehicle Weight Rating (GVWR) located on your vehicle's identification tag.

SAFETY NOTICE: We recommend installation be done by a professional or persons with sound mechanical knowledge.

WARNING: These instructions are a general guide for installation. SuperSprings International, Inc. assumes no liability for the actual installation process. Consumers and installers should apply common automotive safety practices when raising and working on any vehicle. **Do not put yourself in a position where, if the vehicle were to move**

unexpectedly, you may be injured. SuperSprings' products are designed to improve vehicle ride quality. Do not load any vehicle beyond the manufacturer's specifications.

BEFORE INSTALLATION: Ensure the vehicle is on a level surface, the parking brake is ON, with the ignition OFF, and place blocks in front of and behind the front tires to prevent the vehicle from moving.

DURING AND/OR AFTER INSTALLATION: Ensure emergency brake cables are not touching the SuperSprings. Secure any cables out of the way with zip ties or by re-routing. **Ensure all A/C lines, brake cables and frame are clear of contact or interference.**

1. Park vehicle on a level hard surface. Engage emergency brake. Place blocks in front and behind rear wheels to prevent rolling. Observe all safety precautions and wear safety glasses.
2. Raise front of vehicle allowing the axle to hang freely. Support the frame using safety jack stands.
3. Remove existing factory jounce bumper assembly by grasping it firmly and with a twisting and pulling motion, work it until the jounce bumper pops out of the retaining cup. It can also be pried out of the retaining cup utilizing a large flat blade screwdriver.
4. Select the Driver's Side SumoSprings Assembly and position the assembly into the retaining cup at the correct orientation [see diagram above – arrow pointing forward]. Place the 2"x4" block between the underside of SumoSprings and the jounce pad on the axle. Raise the axle by jacking on the underside of the axle until the SumoSprings is fully seated in the retainer cup [alternatively lower the vehicle slowly to achieve same].
5. Repeat steps three through four on the passenger side of the vehicle.
6. Jack up vehicle, remove safety jack stands.
7. Carefully lower vehicle to the ground. Remove the blocks in front and back of the rear wheels.
8. Release emergency brake.
9. Fill out warranty your warranty information at: supersprings.com/warranty/

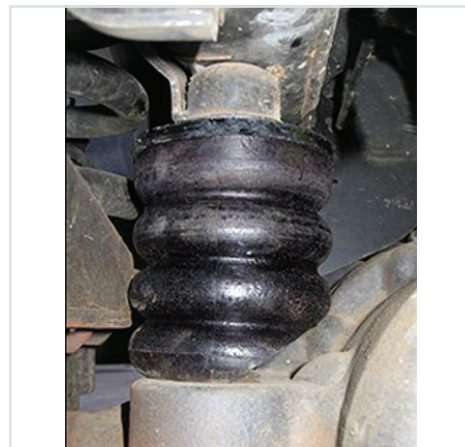

Drivers Side Installed - The notched SumoSprings is installed on the drivers side

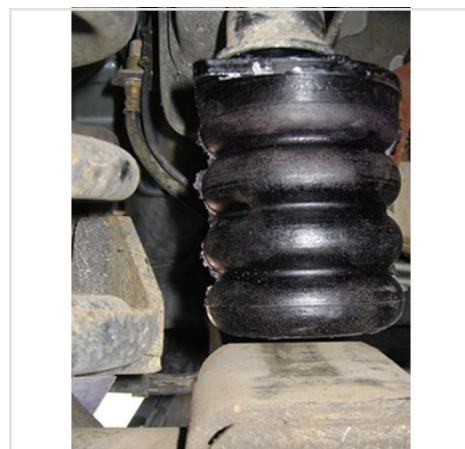

Passengers Side Installed

SuperSprings International, Inc.

505 Maple Avenue
Carpinteria, CA 93013

Technical Support

+1 (805) 745-5553
tech@supersprings.com

supersprings.com



Never exceed the manufacturer's Gross Vehicle Weight Rating (GVWR) located on your vehicle's identification tag.

SAFETY NOTICE: We recommend installation be done by a professional or persons with sound mechanical knowledge.

WARNING: These instructions are a general guide for installation. SuperSprings International, Inc. assumes no liability for the actual installation process. Consumers and installers should apply common automotive safety practices when raising and working on any vehicle. **Do not put yourself in a position where, if the vehicle were to move**

unexpectedly, you may be injured. SuperSprings' products are designed to improve vehicle ride quality. Do not load any vehicle beyond the manufacturer's specifications.

BEFORE INSTALLATION: Ensure the vehicle is on a level surface, the parking brake is ON, with the ignition OFF, and place blocks in front of and behind the front tires to prevent the vehicle from moving.

DURING AND/OR AFTER INSTALLATION: Ensure emergency brake cables are not touching the SuperSprings. Secure any cables out of the way with zip ties or by re-routing. **Ensure all A/C lines, brake cables and frame are clear of contact or interference.**

PRODUCT PHOTOS



SuperSprings International, Inc.

505 Maple Avenue
Carpinteria, CA 93013

Technical Support

+1 (805) 745-5553
tech@supersprings.com

supersprings.com

 **Never exceed the manufacturer's Gross Vehicle Weight Rating (GVWR) located on your vehicle's identification tag.**

SAFETY NOTICE: We recommend installation be done by a professional or persons with sound mechanical knowledge.

WARNING: These instructions are a general guide for installation. SuperSprings International, Inc. assumes no liability for the actual installation process. Consumers and installers should apply common automotive safety practices when raising and working on any vehicle. **Do not put yourself in a position where, if the vehicle were to move**

unexpectedly, you may be injured. SuperSprings' products are designed to improve vehicle ride quality. Do not load any vehicle beyond the manufacturer's specifications.

BEFORE INSTALLATION: Ensure the vehicle is on a level surface, the parking brake is ON, with the ignition OFF, and place blocks in front of and behind the front tires to prevent the vehicle from moving.

DURING AND/OR AFTER INSTALLATION: Ensure emergency brake cables are not touching the SuperSprings. Secure any cables out of the way with zip ties or by re-routing. **Ensure all A/C lines, brake cables and frame are clear of contact or interference.**