

PART NUMBER

**SSF-327-47**



**BEFORE YOU BEGIN**

**PRIMARY APPLICATION**

- › Freightliner Sprinter 2500 4 X 4 (2015-2021)
- › Freightliner Sprinter 3500 4 X 4 (2015-2021)
- › Mercedes-Benz Sprinter 2500 4 X 4 (2015-2021)
- › Mercedes-Benz Sprinter 3500 4 X 4 (2015-2021)

**TOOLS REQUIRED**

- › Floor jack
- › Safety jack stands
- › Wheel Blocks
- › 13mm wrench or socket

**PARTS LIST**

Item	Part #	Description	QTY
A	511426	SumoSprings Black -47	2
B	512009	2.5" Diameter Space	2
C	512215	M8 Washer	2
D	512219	M8 Nylock Nut	2

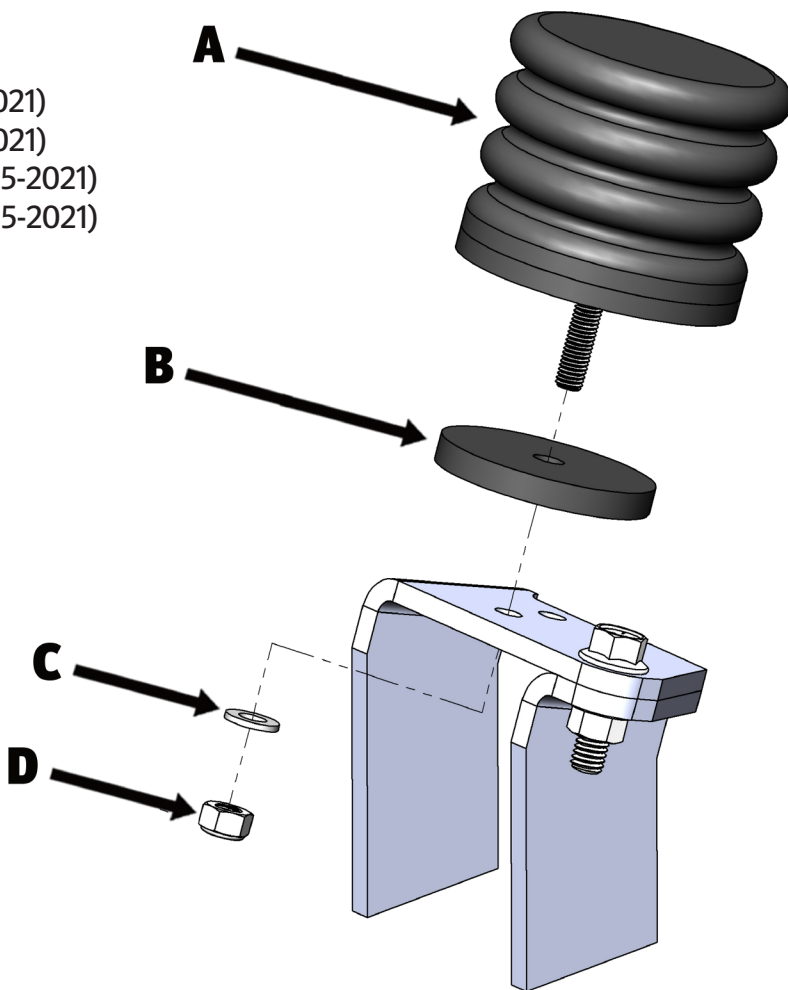

**DRIVER'S SIDE (PASSENGER'S SIDE SIMILAR)**

**Part Number: SSF-327-47**

**› Product Line: SUMOSPRINGS REAR**

**Page 1**

**SuperSprings International, Inc.**

505 Maple Avenue  
Carpenteria, CA 93013

**Installation Support**

+1 (800) 898-0705  
support@supersprings.com

**superspringsint.com**

**SAFETY NOTICE:** We recommend installation be done by a professional or persons with sound mechanical knowledge.

**WARNING:** These instructions are a general guide for installation. SuperSprings International, Inc. assumes no liability for the actual installation process. Consumers and installers should apply common automotive safety practices when raising and working on any vehicle. **Do not put yourself in a position where, if the vehicle were to move unexpectedly, you may be injured.** SuperSprings' products are designed to improve vehicle ride quality. Do not load any vehicle beyond the manufacturer's specifications.

**Never exceed the manufacturer's Gross Vehicle Rating (GVWR) located on your vehicles identification tag.**

**BEFORE INSTALLATION:** Ensure the vehicle is on a level surface, the parking brake is ON, with the ignition OFF, and place blocks in front of and behind the front tires to prevent the vehicle from moving.

**DURING AND/OR AFTER INSTALLATION:** Ensure emergency brake cables are not touching the SuperSprings. Secure any cables out of the way with zip ties or by re-routing. **Ensure all A/C lines, brake cables, and frame are clear of contact or interference.**

**REV. 001 | AUGUST 2021**

PART NUMBER

**SSF-327-47**



**IMPORTANT NOTICE:** Your part may have been loosely preassembled to show the final product as it will be once installed on your vehicle. Please disassemble the product before proceeding to the installation.

**INSTALLATION**

1. Park the vehicle on a hard, level surface and engage the emergency brake. Place blocks in front and behind the wheels to prevent rolling. Observe all safety precautions and wear safety glasses.
2. Raise the front of the vehicle allowing the axle to hang freely and rest the frame on the safety jack stands rated for the weight of the vehicle. Removal of the front wheels is optional.
3. Remove factory bump stop from its mounting bracket.
4. Place the Spacer [ITEM B] on the stud of the SumoSpring [ITEM A].
5. Install the Sumospring onto the factory mounting bracket. Ensure the stud is inserted into the same hole that the factory bump stop was removed from (upper hole).
6. Place the Flat Washer [ITEM C] over the stud and thread on the M8 Nylock Nut [ITEM D] and torque to 20 ft. lbs.
7. Repeat steps 3-6 on the other side of the vehicle.
8. Raise the vehicle, remove safety jack stands, and carefully lower vehicle to the hard surface. Remove the blocks in front and back of the rear wheels and release the emergency brake.
9. Register the warranty for your SuperSprings International part. A warranty card can be found in the box your part came in.