

PART NUMBER

## SSR-327-40-2/47-2



**INSTALLATION VIDEO:** To see a video of this installation, please visit our youtube page - [youtube.com/superspringsinternational](https://www.youtube.com/superspringsinternational)  
<https://youtu.be/HmESKWAHiEc>

### BEFORE YOU BEGIN

#### PRIMARY APPLICATION

- › Mercedes-Benz Sprinter 2500 2WD (2013-2016)
- › Freightliner 2500 2WD (2013-2016)
- › Mercedes-Benz Sprinter 2500 4WD (2015-present)
- › Freightliner 2500 4WD (2015-2018)

#### TOOLS REQUIRED

- › Floor jack
- › Safety jack stands
- › 9/16 wrench
- › 9/16 socket
- › 7/32 Allen Key

#### PARTS LIST

Item	Part #	Description	QTY
A	511415	SumoSpring -40 Blue	2
	511412	SumoSpring -47 Black	2
B	512076	Upper Spacer Bracket	2
C	512077	Upper frame bracket RHS	1
	512088	Upper frame bracket LHS	1
D	512078	Heat Shield	1
E	512075	Upper T-bracket	2
F	512080	Lower axle bracket angle	2
G	512121	Lower axle bracket	2
H	512081	Lower axle clamp	2
I	512207	3/8-16 x 3/4" serrated flange bolt	2
J	512245	3/4-16 X 7/8" FHCS	10
K	512360	3/8 x 3/4" set screws	2
L	512289	3/8 x 16X6" FHCS	4
M	512302	3/8-16 top-lock nut	4
N	512302	3/8-16 top-lock nut	4

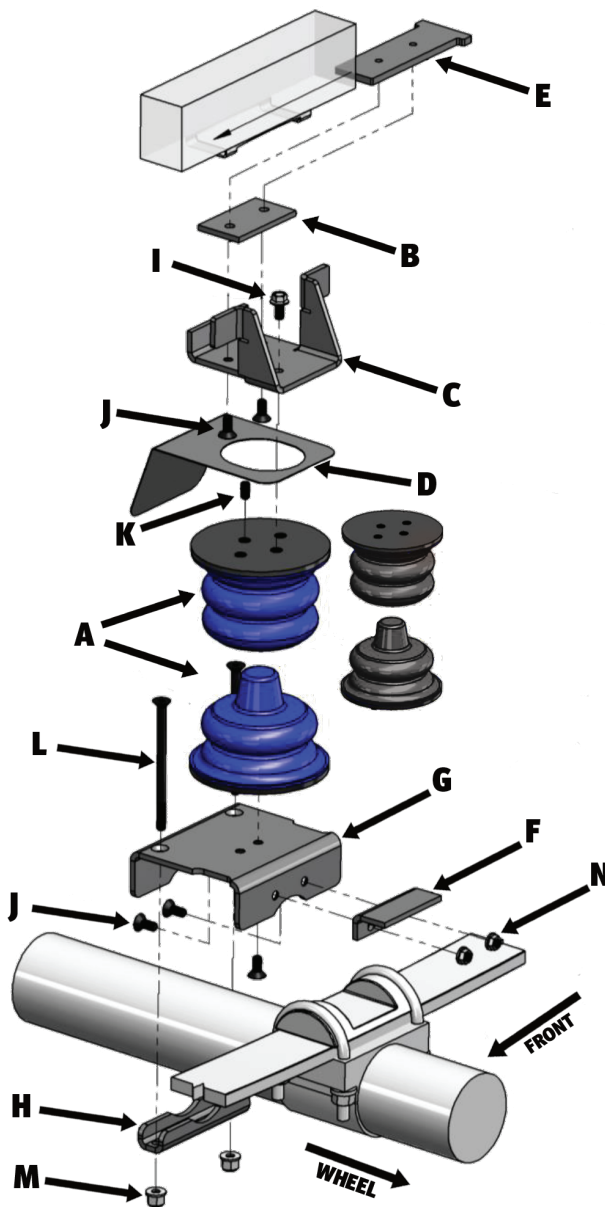

**PASSENGER SIDE (DRIVER'S SIDE SIMILAR)**

Part Number: SSR-327-40-2/47-2

Product Line: SUMOSPRINGS REAR

Page 1

#### SuperSprings International, Inc.

505 Maple Avenue  
Carpinteria, CA 93013

#### Installation Support

+1 (800) 898-0705  
support@supersprings.com

superspringsinternational.com

**SAFETY NOTICE:** We recommend installation be done by a professional or persons with sound mechanical knowledge.

**WARNING:** These instructions are a general guide for installation. SuperSprings International, Inc. assumes no liability for the actual installation process. Consumers and installers should apply common automotive safety practices when raising and working on any vehicle. **Do not put yourself in a position where, if the vehicle were to move unexpectedly, you may be injured.** SuperSprings' products are designed to improve vehicle ride quality. Do not load any vehicle beyond the manufacturer's specifications.

**Never exceed the manufacturer's Gross Vehicle Rating (GVWR) located on your vehicles identification tag.**

**BEFORE INSTALLATION:** Ensure the vehicle is on a level surface, the parking brake is ON, with the ignition OFF, and place blocks in front of and behind the front tires to prevent the vehicle from moving.

**DURING AND/OR AFTER INSTALLATION:** Ensure emergency brake cables are not touching the SuperSprings. Secure any cables out of the way with zip ties or by re-routing. **Ensure all A/C lines, brake cables, and frame are clear of contact or interference.**

PART NUMBER

**SSR-327-40-2/47-2**



**IMPORTANT NOTICE:** Your part may have been loosely preassembled to show the final product as it will be once installed on your vehicle. Please disassemble the product before proceeding to the installation.

**INSTALLATION**

1. Park the vehicle on a hard, level surface and engage the emergency brake. Place blocks in front and behind the wheels to prevent rolling. Observe all safety precautions and wear safety glasses.
2. Raise the vehicle until the axle hangs free. Rest the frame on safety jack stands rated for the weight of the vehicle. Removal of the wheel is optional.
3. Starting on either side. Remove the factory bumpstop from the underside of the frame and set aside. These would be removed by pulling sideways firmly and rotating them out of the holders. Also remove the factory bump stop spacer blocks from the axle by unbolting the swaybar mount from the axle bracket, remove the bump stop spacer block and bracket, then reattach the swaybar mount to the axle bracket.
4. Remove the upper bracket assembly [ITEM E], [ITEM B] and [ITEM C] from the box. Slide the upper T-bracket [ITEM E] into the bump-stop holder bracket underside the frame from the rear. Attach the upper frame bracket and upper spacer [ITEM B] to the upper T-bracket using two 3/8-16 X 7/8" flat head cap-screws [ITEM J] and secure tightly. Ensure you orientate the upper frame bracket with the two vertical flanges outside the frame toward the wheel.
5. Remove the lower bracket assembly [ITEM F,G & H] from the box. Assemble the lower axle bracket [ITEM G] and lower axle bracket angle [ITEM F] using two 3/8-16 X 7/8" flat head cap-screws [ITEM J] and 3/8-16 top-lock nuts [ITEM N]. Then attach the assembly to the underside of the Sumospring [ITEM A] using a 3/8-16 X 5/8" flat head cap-screw. Ensure you engage the rear hole of the two options in the lower axle bracket [ITEM G] and tighten securely.
6. Place the assembly on the driver's side axle housing with the lower axle bracket angle [ITEM F] sitting between the factory u-bolts and up against the factory spring-pack. In instances where the exhaust pipe runs in close proximity to the Sumospring [ITEM A] then insert the heat shield [ITEM D]. Secure the top of the Sumospring [ITEM A] to the upper frame bracket [ITEM B & C] using a 7/8-16 X 3/4" serrated flange bolts [ITEM I] and a 3/8-16 X 3/4" set screw [ITEM K] as a locating and anti rotation pin.
7. Attach the lower bracket assembly to the axle using the lower axle clamp [ITEM H] and two 3/8-16 X 6" flat head cap screws [ITEM L] and 3/8-16 top-lock nuts [ITEM M].

**Part Number: SSR-327-40-2/47-2**

**Product Line: SUMOSPRINGS REAR**

**Page 2**

**SuperSprings International, Inc.**  
505 Maple Avenue  
Carpinteria, CA 93013  
  
**Installation Support**  
+1 (800) 898-0705  
support@supersprings.com  
  
superspringsinternational.com

**SAFETY NOTICE:** We recommend installation be done by a professional or persons with sound mechanical knowledge.  
**WARNING:** These instructions are a general guide for installation. SuperSprings International, Inc. assumes no liability for the actual installation process. Consumers and installers should apply common automotive safety practices when raising and working on any vehicle. **Do not put yourself in a position where, if the vehicle were to move unexpectedly, you may be injured.** SuperSprings' products are designed to improve vehicle ride quality. Do not load any vehicle beyond the manufacturer's specifications.

**Never exceed the manufacturer's Gross Vehicle Rating (GVWR) located on your vehicles identification tag.**  
**BEFORE INSTALLATION:** Ensure the vehicle is on a level surface, the parking brake is ON, with the ignition OFF, and place blocks in front of and behind the front tires to prevent the vehicle from moving.  
**DURING AND/OR AFTER INSTALLATION:** Ensure emergency brake cables are not touching the SuperSprings. Secure any cables out of the way with zip ties or by re-routing. **Ensure all A/C lines, brake cables, and frame are clear of contact or interference.**

PART NUMBER

**SSR-327-40-2/47-2**



**IMPORTANT NOTICE:** Your part may have been loosely preassembled to show the final product as it will be once installed on your vehicle. Please disassemble the product before proceeding to the installation.

**INSTALLATION**

8. Repeat steps 3-7 on the passenger's side of the vehicle. Ensure to install the heat shield [ITEM D] between the top of the SumoSpring [ITEM A] and upper bracket [ITEM C]. Please note that on the passenger's side it is important to secure the bottom of the Sumospring [ITEM A] to the lower axle bracket [ITEM G] in the rear bolt hole position as described in point 5 above. (see assembly diagram above)
9. Raise the vehicle to allow room to remove the safety jack stands, carefully lower your vehicle to the hard surface, and remove the blocks from the wheels.
10. Register the warranty for your SuperSprings International part. A warranty card can be found in the box your part came in.

**SuperSprings International, Inc.**

505 Maple Avenue  
Carpinteria, CA 93013

**Installation Support**

+1 (800) 898-0705  
support@supersprings.com

superspringsinternational.com

**SAFETY NOTICE:** We recommend installation be done by a professional or persons with sound mechanical knowledge.

**WARNING:** These instructions are a general guide for installation. SuperSprings International, Inc. assumes no liability for the actual installation process. Consumers and installers should apply common automotive safety practices when raising and working on any vehicle. **Do not put yourself in a position where, if the vehicle were to move unexpectedly, you may be injured.** SuperSprings' products are designed to improve vehicle ride quality. Do not load any vehicle beyond the manufacturer's specifications.

**Never exceed the manufacturer's Gross Vehicle Rating (GVWR) located on your vehicles identification tag.**

**BEFORE INSTALLATION:** Ensure the vehicle is on a level surface, the parking brake is ON, with the ignition OFF, and place blocks in front of and behind the front tires to prevent the vehicle from moving.

**DURING AND/OR AFTER INSTALLATION:** Ensure emergency brake cables are not touching the SuperSprings. Secure any cables out of the way with zip ties or by re-routing. **Ensure all A/C lines, brake cables, and frame are clear of contact or interference.**